



A·C·T

Environmental & Infrastructure

PROFESSIONAL CONTRACTING SERVICES

ASBESTOS SURVEY REPORT

FACILITY NAME

Publix Store No. 266
Tenant No. 4
Punta Gorda Crossing Shopping Center
2310 Tamiami Trail
Punta Gorda, Florida 33950

FACILITY OWNER

Publix Super Markets Inc.
Post Office Box 407
Lakeland, Florida 33802-0407

SURVEY DATE:

December 1, 2022

REPORT DATE:

December 12, 2022

A-C-T PROJECT #:

27965

James D. Stump, P.G.
Accredited Facility Inspector

Eric Jonsson, CIH
Licensed Asbestos Consultant

TABLE OF CONTENTS

<u>Section No.</u>		<u>Page No.</u>
1.0	INTRODUCTION	1
2.0	BUILDING/FACILITY DESCRIPTION.....	1
3.0	SUMMARY OF FINDINGS.....	1
4.0	RECOMMENDATIONS.....	1
5.0	ASBESTOS SURVEY GUIDELINES	2
6.0	HOMOGENEOUS AREAS.....	2
7.0	ASBESTOS ABATEMENT OPINION OF PROBABLE COST.....	3
8.0	DISCLAIMER.....	3
9.0	FIGURE	3

LIST OF TABLES

<u>Table No.</u>		<u>Page No.</u>
1	SUMMARY OF FINDINGS.....	1
2	HOMOGENEOUS AREAS.....	2

LIST OF APPENDICES

Appendix No.

- A HA PHOTOGRAPHS
 - B LABORATORY DATA
 - C BUSINESS, CONSULTANT, AND INSPECTOR CERTIFICATIONS
-

1.0 INTRODUCTION

The purpose of this survey was to identify asbestos-containing material (ACM) and its location in the interior areas of Tenant No. 4 at Publix Store No. 266, located in the Punta Gorda Crossing Shopping Center at 2310 Tamiami Trail, in Punta Gorda, Florida. The survey was conducted on December 1, 2022, by James D. Stump, accredited facility inspector, under the direction of Eric Jonsson, Licensed Asbestos Consultant.

2.0 BUILDING/FACILITY DESCRIPTION

This shopping center is a one-story masonry commercial building generally consisting of concrete block walls erected over concrete slab floors.

3.0 SUMMARY OF FINDINGS

The following table shows the building materials identified as ACM within this location.

**Table I. Summary of Findings
Publix Store No. 266, Tenant No. 4**

Homogeneous Area No.	ACM Description	Location	Approx. Quantity	Asbestos Content	NF/F	Hazard Ranking
<i>Publix Store No. 266, Tenant No. 4 - Interior Only</i>						
No Asbestos Containing Materials Detected						

NF = Non – Friable Material
F = Friable Material

4.0 RECOMMENDATIONS

Interior areas of Tenant No. 4 at Publix Store No. 266 were accessible to the facility inspector during this survey. As laboratory results indicate, no ACM was detected inside the tenant space during this survey. Therefore, no recommendations are necessary at this time.

5.0 ASBESTOS SURVEY GUIDELINES

Prior to the performance of this asbestos survey, Publix Super Markets, Inc. notified all respective Publix representatives and managers that this inspection would be performed.

For additional Asbestos Survey Guidelines and Hazard Assessment information, refer to the Publix supplemental document: Publix Asbestos Management Program Guidelines.

6.0 HOMOGENEOUS AREAS

The following table includes the various suspect building materials that were accessible and observed during the asbestos survey. However, because destructive sampling was not authorized, areas such as voids, cavities, and other inaccessible spaces may contain suspect ACM.

**Table II. Homogeneous Areas
Publix Store No. 266, Tenant No. 4**

Homogeneous Area No.	Material Description	Sample Number	Location	ACM Y/N
<i>Publix Store No. 266, Tenant No. 4 – Interior Only</i>				
01	2'x4' White Wormhole Pattern Ceiling Tile	1-1 to 1-4	Throughout	N
02	Red Putty	2-1 to 2-3	Exterior Wall Pipe Penetrations	N
03	Drywall and Joint Compound	3-1 to 3-3	Throughout	N

7.0 ASBESTOS ABATEMENT OPINION OF PROBABLE COST

Because no ACMs were identified within the accessible areas of this store during this survey, no asbestos abatement opinion of probable cost is necessary at this time.

8.0 DISCLAIMER

All documents prepared by A-C-T, including, but not limited to, drawings and specifications, are related exclusively to the services provided herein. They are not intended or represented to be suitable for reuse by Publix Super Markets, Inc., or others on extensions of this project or on any other project. Any reuse without written verification or adaption by A-C-T for specific purposes intended, will be at the sole risk of Publix Super Markets, Inc., and without liability or legal exposure to A-C-T, Publix Super Markets, Inc. shall indemnify and hold A-C-T harmless from all claims, damages, losses and expenses, including, but not limited to, attorney's fees arising out of or resulting there from. Any such verification or adaption will entitle A-C-T to further compensation at rates to be agreed upon by Publix Super Markets, Inc., and A-C-T. This report, consisting of narrative and attachments, must be considered and utilized in its entirety.

9.0 FIGURE

The floor plan for subject tenant space illustrating sampling locations has been included on the following page.

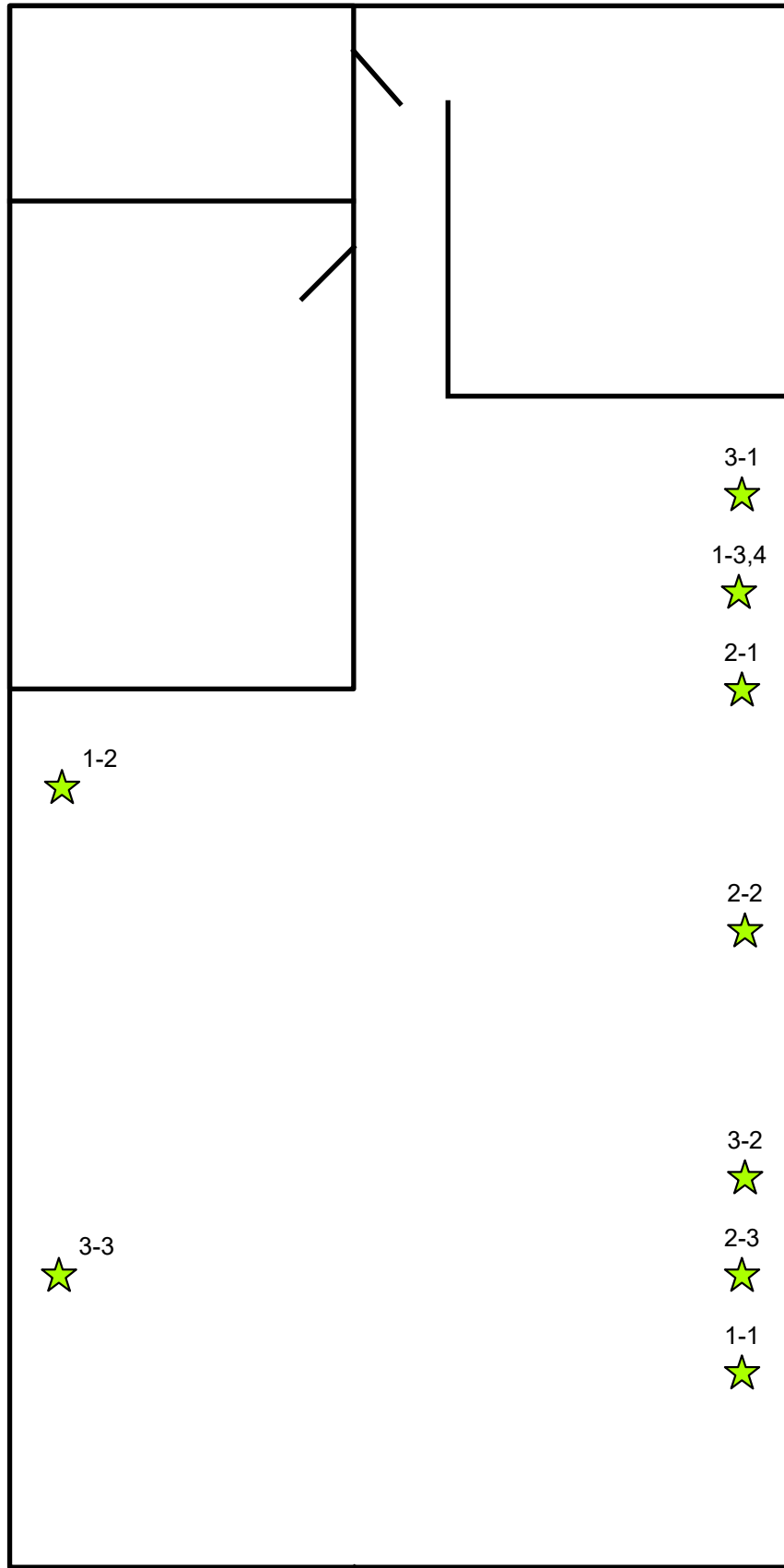

Sampling Locations Map

Publix Supermarkets, Inc.

Publix Store No. 266, Tenant No. 4
 Punta Gorda Crossing
 2310 Tamiami Trail
 Punta Gorda, Florida

Figure: 1

Project No.: 27965

Date: 12/02/2022

Created By: MJB

Source: ACT 2022



Asbestos Survey Report

**Publix Store No. 266, Tenant No. 4
ACT Project #27965**

APPENDIX A

HA PHOTOGRAPHS



PHOTO # 1: REPRESENTATIVE VIEW OF HA 1-1, 2, 3, 4.



PHOTO # 2: REPRESENTATIVE VIEW OF HA 2-1, 2, 3.



PHOTO # 3: REPRESENTATIVE VIEW OF HA 3-1, 2, 3.



Asbestos Survey Report

**Publix Store No. 266, Tenant No. 4
ACT Project #27965**

APPENDIX B

LABORATORY DATA

December 8, 2022

ACT Inc

1875 W. Main Street
Bartow, FL 33830

CLIENT PROJECT: PSM Store 266 Tenant 4, 27965
CEI LAB CODE: B2217388

Dear Customer:

Enclosed are asbestos analysis results for PLM Bulk samples received at our laboratory on December 6, 2022. The samples were analyzed for asbestos using polarizing light microscopy (PLM) per the EPA 600 Method.

Sample results containing >1% asbestos are considered asbestos-containing materials (ACMs) per EPA regulatory requirements. The detection limit for the EPA 600 Method is <1% asbestos by weight as determined by visual estimation.

Thank you for your business and we look forward to continuing good relations.

Kind Regards,

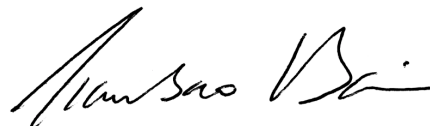

Tianbao Bai, Ph.D., CIH
Laboratory Director



CEI

ASBESTOS ANALYTICAL REPORT

By: Polarized Light Microscopy

Prepared for

ACT Inc

CLIENT PROJECT: PSM Store 266 Tenant 4, 27965

LAB CODE: B2217388

TEST METHOD: EPA 600 / R93 / 116 and EPA 600 / M4-82 / 020

REPORT DATE: 12/08/22

TOTAL SAMPLES ANALYZED: 10

SAMPLES >1% ASBESTOS:



CEI

Asbestos Report Summary

By: POLARIZING LIGHT MICROSCOPY

PROJECT: PSM Store 266 Tenant 4, 27965

LAB CODE: B2217388

METHOD: EPA 600 / R93 / 116 and EPA 600 / M4-82 / 020

Client ID	Layer	Lab ID	Color	Sample Description	ASBESTOS %
1-1		B2217388.01	White	Ceiling Tile	None Detected
1-2		B2217388.02	White	Ceiling Tile	None Detected
1-3		B2217388.03	White	Ceiling Tile	None Detected
1-4		B2217388.04	White	Ceiling Tile	None Detected
2-1		B2217388.05	Red	Putty	None Detected
2-2		B2217388.06	Red	Putty	None Detected
2-3		B2217388.07	Red	Putty	None Detected
3-1		B2217388.08	White,Tan	Drywall/Joint Compound	None Detected
3-2		B2217388.09	White,Tan	Drywall/Joint Compound	None Detected
3-3		B2217388.10	White,Tan	Drywall/Joint Compound	None Detected

ASBESTOS BULK ANALYSIS

By: POLARIZING LIGHT MICROSCOPY

Client: **ACT Inc**
 1875 W. Main Street
 Bartow, FL 33830

Lab Code: B2217388
Date Received: 12-06-22
Date Analyzed: 12-08-22
Date Reported: 12-08-22

Project: PSM Store 266 Tenant 4, 27965

ASBESTOS BULK PLM, EPA 600 METHOD

Client ID Lab ID	Lab Description	Lab Attributes	NON-ASBESTOS COMPONENTS				ASBESTOS %
			Fibrous		Non-Fibrous		
1-1 B2217388.01	Ceiling Tile	Heterogeneous White Fibrous Loosely Bound	60%	Cellulose Fiberglass	15%	Perlite Paint	None Detected
1-2 B2217388.02	Ceiling Tile	Heterogeneous White Fibrous Loosely Bound	60%	Cellulose Fiberglass	15%	Perlite Paint	None Detected
1-3 B2217388.03	Ceiling Tile	Heterogeneous White Fibrous Loosely Bound	60%	Cellulose Fiberglass	15%	Perlite Paint	None Detected
1-4 B2217388.04	Ceiling Tile	Heterogeneous White Fibrous Loosely Bound	60%	Cellulose Fiberglass	15%	Perlite Paint	None Detected
2-1 B2217388.05	Putty	Homogeneous Red Fibrous Bound	10%	Fiberglass	90%	Caulk	None Detected
2-2 B2217388.06	Putty	Homogeneous Red Fibrous Bound	10%	Fiberglass	90%	Caulk	None Detected
2-3 B2217388.07	Putty	Homogeneous Red Fibrous Bound	10%	Fiberglass	90%	Caulk	None Detected

ASBESTOS BULK ANALYSIS

By: POLARIZING LIGHT MICROSCOPY

Client: **ACT Inc**
 1875 W. Main Street
 Bartow, FL 33830

Lab Code: B2217388
Date Received: 12-06-22
Date Analyzed: 12-08-22
Date Reported: 12-08-22

Project: PSM Store 266 Tenant 4, 27965

ASBESTOS BULK PLM, EPA 600 METHOD

Client ID Lab ID	Lab Description	Lab Attributes	NON-ASBESTOS COMPONENTS				ASBESTOS %
			Fibrous	Cellulose	Non-Fibrous		
3-1 B2217388.08	Drywall/Joint Compound	Heterogeneous White, Tan Fibrous Bound	20%	Cellulose	75% 5% <1%	Gypsum Calc Carb Paint	None Detected
3-2 B2217388.09	Drywall/Joint Compound	Heterogeneous White, Tan Fibrous Bound	20%	Cellulose	75% 5% <1%	Gypsum Calc Carb Paint	None Detected
3-3 B2217388.10	Drywall/Joint Compound	Heterogeneous White, Tan Fibrous Bound	20%	Cellulose	75% 5% <1%	Gypsum Calc Carb Paint	None Detected

LEGEND: Non-Anth = Non-Asbestiform Anthophyllite
Non-Trem = Non-Asbestiform Tremolite
Calc Carb = Calcium Carbonate

METHOD: EPA 600 / R93 / 116 and EPA 600 / M4-82 / 020

REPORTING LIMIT: <1% by visual estimation

REPORTING LIMIT FOR POINT COUNTS: 0.25% by 400 Points or 0.1% by 1,000 Points

REGULATORY LIMIT: >1% by weight

Due to the limitations of the EPA 600 method, nonfriable organically bound materials (NOBs) such as vinyl floor tiles can be difficult to analyze via polarized light microscopy (PLM). EPA recommends that all NOBs analyzed by PLM, and found not to contain asbestos, be further analyzed by Transmission Electron Microscopy (TEM). Please note that PLM analysis of dust and soil samples for asbestos is not covered under NVLAP accreditation. *Estimated measurement of uncertainty is available on request.*

This report relates only to the samples tested or analyzed and may not be reproduced, except in full, without written approval by Eurofins CEI. Eurofins CEI makes no warranty representation regarding the accuracy of client submitted information in preparing and presenting analytical results. Interpretation of the analytical results is the sole responsibility of the client. Samples were received in acceptable condition unless otherwise noted. This report may not be used by the client to claim product endorsement by NVLAP or any other agency of the U.S. Government.

Information provided by customer includes customer sample ID and sample description.

ANALYST:

Zane Heinz

APPROVED BY:

Tianbao Bai, Ph.D., CIH
Laboratory Director



CHAIN OF CUSTODY

10

CEI

730 SE Maynard Road, Cary, NC 27511
 Tel: 866-481-1412; Fax: 919-481-1442

LAB USE ONLY:

CEI Lab Code: **B2217388**

CEI Lab I.D. Range:

COMPANY INFORMATION		PROJECT INFORMATION	
CEI CLIENT #:		Job Contact:	Eric Jonsson
Company:	A-C-T	Email / Tel:	863-559-0188
Address:	1875 West Main Street Bartow, FL 33830	Project Name:	PSM Store 266 Tenant A
Email:	ejonsson@a-c-t.com	Project ID#:	27965
Tel:	863 559 0188	Fax:	
		STATE SAMPLES COLLECTED IN:	FL

IF TAT IS NOT MARKED STANDARD 3 DAY TAT APPLIES.

ASBESTOS	METHOD	TURN AROUND TIME					
		4 HR	8 HR	1 DAY	2 DAY	3 DAY	5 DAY
PLM BULK	EPA 600	<input type="checkbox"/>	<input type="checkbox"/>	<input type="checkbox"/>	<input type="checkbox"/>	<input checked="" type="checkbox"/>	<input type="checkbox"/>
PLM POINT COUNT (400)	EPA 600	<input type="checkbox"/>	<input type="checkbox"/>	<input type="checkbox"/>	<input type="checkbox"/>	<input type="checkbox"/>	<input type="checkbox"/>
PLM POINT COUNT (1000)	EPA 600	<input type="checkbox"/>	<input type="checkbox"/>	<input type="checkbox"/>	<input type="checkbox"/>	<input type="checkbox"/>	<input type="checkbox"/>
PLM GRAV w POINT COUNT	EPA 600	<input type="checkbox"/>	<input type="checkbox"/>	<input type="checkbox"/>	<input type="checkbox"/>	<input type="checkbox"/>	<input type="checkbox"/>
PLM BULK	CARB 435	<input type="checkbox"/>	<input type="checkbox"/>	<input type="checkbox"/>	<input type="checkbox"/>	<input type="checkbox"/>	<input type="checkbox"/>
PCM AIR	NIOSH 7400	<input type="checkbox"/>	<input type="checkbox"/>	<input type="checkbox"/>	<input type="checkbox"/>	<input type="checkbox"/>	<input type="checkbox"/>
TEM AIR	EPA AHERA	<input type="checkbox"/>	<input type="checkbox"/>	<input type="checkbox"/>	<input type="checkbox"/>	<input type="checkbox"/>	<input type="checkbox"/>
TEM AIR	NIOSH 7402	<input type="checkbox"/>	<input type="checkbox"/>	<input type="checkbox"/>	<input type="checkbox"/>	<input type="checkbox"/>	<input type="checkbox"/>
TEM AIR (PCME)	ISO 10312	<input type="checkbox"/>	<input type="checkbox"/>	<input type="checkbox"/>	<input type="checkbox"/>	<input type="checkbox"/>	<input type="checkbox"/>
TEM AIR	ASTM 6281-15	<input type="checkbox"/>	<input type="checkbox"/>	<input type="checkbox"/>	<input type="checkbox"/>	<input type="checkbox"/>	<input type="checkbox"/>
TEM BULK	CHATFIELD	<input type="checkbox"/>	<input type="checkbox"/>	<input type="checkbox"/>	<input type="checkbox"/>	<input type="checkbox"/>	<input type="checkbox"/>
TEM DUST WIPE	ASTM D6480-05 (2010)	<input type="checkbox"/>	<input type="checkbox"/>	<input type="checkbox"/>	<input type="checkbox"/>	<input type="checkbox"/>	<input type="checkbox"/>
TEM DUST MICROVAC	ASTM D5755-09 (2014)	<input type="checkbox"/>	<input type="checkbox"/>	<input type="checkbox"/>	<input type="checkbox"/>	<input type="checkbox"/>	<input type="checkbox"/>
TEM SOIL	ASTM D7521-16	<input type="checkbox"/>	<input type="checkbox"/>	<input type="checkbox"/>	<input type="checkbox"/>	<input type="checkbox"/>	<input type="checkbox"/>
TEM VERMICULITE	CINCINNATI METHOD	<input type="checkbox"/>	<input type="checkbox"/>	<input type="checkbox"/>	<input type="checkbox"/>	<input type="checkbox"/>	<input type="checkbox"/>
TEM QUALITATIVE	IN-HOUSE METHOD	<input type="checkbox"/>	<input type="checkbox"/>	<input type="checkbox"/>	<input type="checkbox"/>	<input type="checkbox"/>	<input type="checkbox"/>
OTHER:		<input type="checkbox"/>	<input type="checkbox"/>	<input type="checkbox"/>	<input type="checkbox"/>	<input type="checkbox"/>	<input type="checkbox"/>

REMARKS / SPECIAL INSTRUCTIONS:

Accept Samples
 Reject Samples

Relinquished By:	Date/Time	Received By:	Date/Time
[Signature]	12/2/22 1600	BMB	12/2 10:20

Samples will be disposed of 30 days after analysis

APPENDIX C

BUSINESS, CONSULTANT, AND INSPECTOR CERTIFICATIONS



Ron DeSantis, Governor

Julie I. Brown, Secretary



**STATE OF FLORIDA
DEPARTMENT OF BUSINESS AND PROFESSIONAL REGULATION**

ASBESTOS LICENSING UNIT

THE ASBESTOS BUSINESS ORGANIZATION HEREIN IS LICENSED UNDER THE
PROVISIONS OF CHAPTER 469, FLORIDA STATUTES

AMERICAN COMPLIANCE TECHNOLOGIES, INC.

ROBERT KINCART
1875 WEST MAIN STREET
BARTOW FL 33830

LICENSE NUMBER: ZA334

EXPIRATION DATE: NOVEMBER 30, 2023

Always verify licenses online at MyFloridaLicense.com



Do not alter this document in any form.

This is your license. It is unlawful for anyone other than the licensee to use this document.



Ron DeSantis, Governor

Halsey Beshears, Secretary



STATE OF FLORIDA
DEPARTMENT OF BUSINESS AND PROFESSIONAL REGULATION

ASBESTOS LICENSING UNIT

THE ASBESTOS CONSULTANT HEREIN IS LICENSED UNDER THE
PROVISIONS OF CHAPTER 469, FLORIDA STATUTES

JONSSON, ERIC ANDREW

AMERICAN COMPLIANCE TECHNOLOGIES, INC.
1875 WEST MAIN STREET
BARTOW FL 33830

LICENSE NUMBER: AX83

EXPIRATION DATE: NOVEMBER 30, 2022

Always verify licenses online at MyFloridaLicense.com



Do not alter this document in any form.

This is your license. It is unlawful for anyone other than the licensee to use this document.

United States Department of Commerce
National Institute of Standards and Technology



Certificate of Accreditation to ISO/IEC 17025:2017

NVLAP LAB CODE: 101768-0

Eurofins CEL, Inc.
Cary, NC

is accredited by the National Voluntary Laboratory Accreditation Program for specific services,
listed on the Scope of Accreditation, for:

Asbestos Fiber Analysis

*This laboratory is accredited in accordance with the recognized International Standard ISO/IEC 17025:2017.
This accreditation demonstrates technical competence for a defined scope and the operation of a laboratory quality
management system (refer to joint ISO-ILAC-IAF Communiqué dated January 2009).*

2022-04-01 through 2023-03-31

Effective Dates



For the National Voluntary Laboratory Accreditation Program

SCOPE OF ACCREDITATION TO ISO/IEC 17025:2017

Eurofins CEI, Inc.
730 SE Maynard Road
Cary, NC 27511
Dr. Tianbao Bai
Phone: 919-481-1413 Fax: 919-481-1442
Email: tianbao.bai@eurofinset.com
<http://www.eurofinsus.com/CEI>

ASBESTOS FIBER ANALYSIS

NVLAP LAB CODE 101768-0

Bulk Asbestos Analysis

<u>Code</u>	<u>Description</u>
18/A01	EPA -- 40 CFR Appendix E to Subpart E of Part 763, Interim Method of the Determination of Asbestos in Bulk Insulation Samples
18/A03	EPA 600/R-93/116: Method for the Determination of Asbestos in Bulk Building Materials

Airborne Asbestos Analysis

<u>Code</u>	<u>Description</u>
18/A02	U.S. EPA's "Interim Transmission Electron Microscopy Analytical Methods-Mandatory and Nonmandatory-and Mandatory Section to Determine Completion of Response Actions" as found in 40 CFR, Part 763, Subpart E, Appendix A.

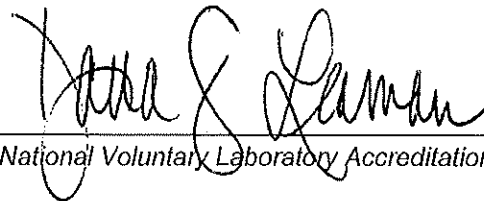

For the National Voluntary Laboratory Accreditation Program

Asbestos Survey & Mechanical (AHERA Building Inspector) Refresher Training

This is to certify that

James Stump

Has attended and completed Refresher training in accordance with
Title II of TSCA, 40 CFR Part 763 Appendix C to Subpart E as revised

Date of Course Completion 8/18/21

Date of Course Examination 8/18/21 with Passing Score of 70% or Higher via online course

Expiration Date 8/18/22

Asbestos Online Training, LLC
727-873-6442
info@asbestosonlinetraining.com

Certificate # 81821-BIR70

Course # FL-490006359 Provider #
FL-490005406



Instructor

123certificates